

ULA On-line Rack Mount Smart UPS

6KVA - 10KVA

PF 1.0



Features

- Advanced True On-line Double Conversion, VFI and DSP with 3 – level technology
- Output power factor 1.0
- Active power factor correction (APFC), input power factor up to 0.99
- High efficiency 95% (up to 98% in ECO mode)
- Advanced digital parallel technology
- Wide input voltage range (110 ~ 288 Vac) and frequency range (40 ~ 70 Hz)
- 50 / 60 Hz frequency auto sensing
- Two modes of frequency conversion: 50 Hz input / 60 Hz output or 60 Hz input / 50 Hz output
- Hot-swappable battery
- Flexible battery configuration (settable 16 - 20 pcs batteries)
- Digitally controlled charger
- High charging current available (Max. 12 A)
- Charging voltage and current configured by demands
- Linear derating in low voltage input reducing battery discharging times, extending the service life of battery
- Intelligent battery management, automatic floating / equalizing charge control, charger dormancy control, increasing battery life by 50%

- Ability to switch on the UPS with batteries
- Auto start when power is restored, reducing the impact on power grid or generator
- Fan speed varies intelligently with temperature, reducing noise and extending its service life
- Equipped with self-aging function
- Compact internal layout, miniaturized the complete unit for small footprint
- LCD+LED display, multi-functional keys operation, friendly human-machine interface
- Powerful background software for parameters configuration
- Advanced multi-platform communications: RS232, USB, RS485, SNMP and dry contacts communication interfaces
- Effective software and hardware protection function, robust self-diagnostic function, and abundant event log for check

Available Options

- RS232/ USB and smart card slot included
- Optional parallel function, battery temperature compensation, SNMP card, RS485 card, dry contacts, EMD, and SMS alarms

Rear Panel

1. Intelligent Slot
2. Fans
3. Parallel Port (optional)
4. RS232
5. EPO
6. USB (optional)
7. Temperature Detection (optional)
8. GND
9. Bypass Breaker
10. Terminal and Cover
11. Battery Pack



Display panel can be rotated

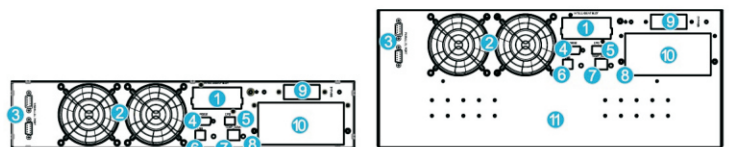

6/10 kVA (H)

6/10 kVA (S)

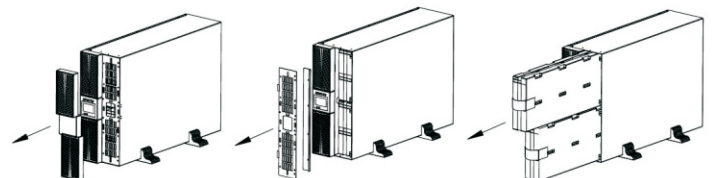

Easy for maintenance, hot-swappable battery

Specifications

MODEL	ULA602RT	ULA103RT
Capacity	6 kVA / 6 kW	10 kVA / 10 kW
INPUT		
Input wiring	Single-phase three-wire (1 Φ + N + PE)	
Rated voltage	208 / 220 / 230 / 240 Vac	
Voltage range	230Vac (or 200/208/220/240 Vac) \pm 25% at 100% loads	
Rated frequency	50 / 60 Hz (auto-sensing)	
Frequency range	40 ~ 70 Hz	
Power factor	\geq 0.99	
Bypass voltage range	- 40% ~ + 15% (settable)	
Total harmonic distortion (THDi)	\leq 5%	
OUTPUT		
Output wiring	Single-phase (L-N)	
Rated voltage	200/208/220/230/240 Vac (Selectable via LCD)	
Voltage regulation	\pm 1%	
Frequency	50Hz / 60Hz (Synchronized to range); 50hz/60Hz \pm 0.1Hz in battery mode	
Waveform	Sinusoidal	
Power factor	1.0	
Total harmonic distortion (THDv)	\leq 1% (linear load); \leq 4% (non-linear load)	
Crest factor	3:1	
Overload capability	Online mode: loads 100% - 110% transfer to bypass in \geq 10 min.; loads 110% - 130% transfer to bypass in \geq 1 min.; Loads >130% transfer to bypass in \geq 1s Bypass mode: loads < 125% working continuously.; loads 125- 150% working in \geq 10s; Loads >150% working in \geq 500ms	
BATTERIES		
Battery type	VRLA Sealed Lead-acid, maintenance free. Built -in including UPS or External Battery Bank acceptable	
DC voltage	192 Vdc (192~240 Vdc settable)	
Inbuilt battery (standard model)	12 V / 7 Ah \times 16	12 V / 9 Ah \times 16
Back-up time	7 min. (full loads) / 15 min. (half loads)	
Charging current (Max.)	Standard model: 1.5 A; Long time model: 5 A (default), 1 ~ 5 A settable, 12 A (optional; PF 0.9)	
Recharge time	Standard model: 90% capacity restored in 5 hours; Long time model: depend on the capacity of battery	
SYSTEM		
Efficiency	\geq 94% at 100% load, max. 94.5% at 60% load, \geq 98% in ECO mode	
Transfer time	Mains mode to Battery mode : 0 ms / Inverter mode to Bypass mode < 4 ms (typical)	
Protections	Short-circuit, overload, overtemperature, battery low voltage, overvoltage, undervoltage and fan failure	
Max. number of parallel connections	4	
Communications	UPSmart Software for RS232 /USB (Standard)RS485 / dry contacts / SNMP / battery temperature compensation (optional)	
LCD + LED Display and Alarm	In/output voltage and frequency; Overload ; Low battery, Battery %; Battery fault; Over temperature, Charger failure, Over charge; ECO mode; Bypass mode; Frequency converter mode...	
OTHERS		
Operating temperature	0°C ~ 40°C	
Storage temperature	-25°C ~ 55°C (without battery)	
Relative humidity	0 ~ 95% (non-condensing)	
Altitude	\leq 1000 m, derating 1% for each additional 100 m	
IP rating/ Safety; EMI, EMS standard	IP20 / IEC 62040-1; IEC 62040-2; IEC 62040-3; IEC 61000-4-2/3/4/5 (ESD/RS/EFT/SURGE)	
Noise level at 1 m	\leq 55 dB	\leq 58 dB
Dimensions (W \times D \times H) (mm)	440 \times 580 \times 88 (H) 440 \times 660 \times 176 (S)	
Packaged dimensions (W \times D \times H) (mm)	514 \times 696 \times 168 (H) 554 \times 792 \times 418 (S)	
Net weight (kg)	12 (H), 58 (S)	14 (H), 63 (S)
Gross weight (kg)	14 (H), 68 (S)	16 (H), 73 (S)

- S means standard model; H means long time model.
- All specifications are subject to change without notice.

Up Select Electronics Co., Ltd.

4F. No.56 Jian Er Rd., Chung Ho City - Taipei - Taiwan R.O.C. Tel: 886 2 22286170 Fax: 886 2 82215491

Up Select Viet Nam Co., Ltd.

Add: Up Select Tower – No.22 Ha Dinh Lake, Ha Dinh St., Thanh Xuan, Ha Noi

Tel: 024. 62751733 - 62850811 * Fax: 024.62751733 * Hotline: 0904292222

Website: www.upselect.com.vn * Email: tuvankythuat@upselect.com; chiendd@upselect.com